

Russellstoll®

Heavy Duty Tumbler Switches

General use heavy duty switches are applied to control a variety of lighting, power and machinery branch circuit loads. They can be used with any Russellstoll industrial receptacle for maximum control system flexibility.

Ordering Information

Watertight



1-2 HP Rated

Switch	125/250 VAC Rating		Cast Aluminum	Cast Brass
	Hp	Amps		
Single Pole / Single Throw	1.5/2.0	15	3705S7	3725S7
	1.0/2.0	20	3705S27	3725S27
	2.0/2.0	30	3705S37	3725S37
Double Pole / Single Throw	1.5/2.0	15	3706D7	3726D7
	1.0/2.0	20	3706D27	3726D27
	2.0/2.0*	30	3706D37	3726D37

Notes:

Switches rated 15 or 20 Amp, 277 volts, A.C. and with other than listed ratings can be furnished. Prices and information on application. AC only.

* Also rated 1 Hp, 460VAC or 2Hp to 600VAC.

Boxes Available in cast aluminum, cat. no. 3701A and cast brass cat. no. 3721.

Specifications

Enclosures – Corrosion resisting baked enamel finish. Cast brass, natural finish.

Gang Types – Can be furnished in 2 gang aluminum or tandem units and in combination with other Russellstoll FS and FD devices. Contact Technical Services.

Outlets – Unless otherwise specified, furnished with one 3/4" outlet per gang, top or bottom. Additional or larger outlets charged extra – see price list. Maximum conduit 1": single gang – top and bottom only, multiple gang – one per gang top and bottom and one each side. Specify size and location.

Flush Mounting – Adapters for flush mounting are listed on page H121.

Dimensions

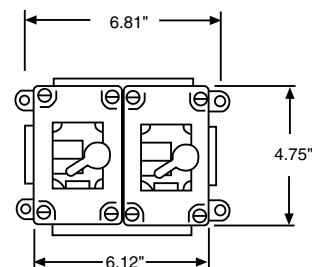
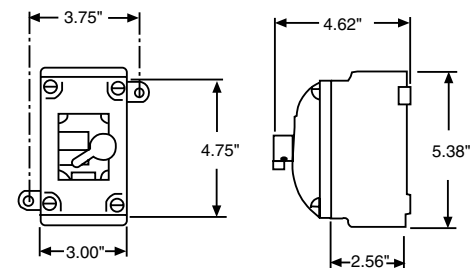

Thomas & Betts