

Russellstoll®

DuraGard® Waterproof Connections – Accessories

Washdown Duty, Chemical, Outdoor, Industrial & Marine Use Non-Metallic Plugs, Connectors Receptacles & Inlets – 20, 30 & 50 Amp, Maximum 600 VAC/250 VDC

Conduit Boxes (For Surface Mounting)

Type FD

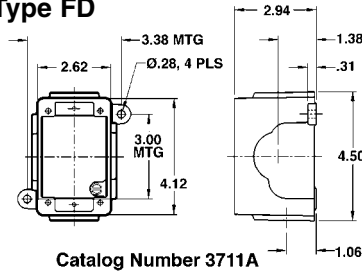

Catalog Number 3711A

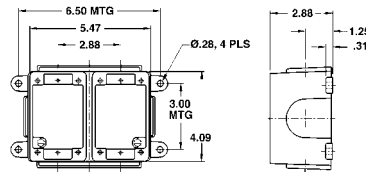

Catalog Number 3712A

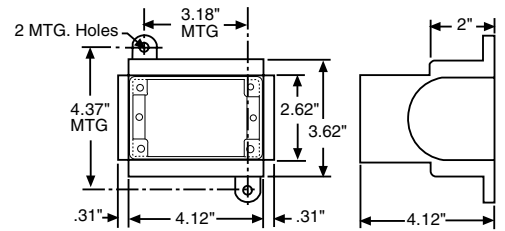

Catalog Number 3781A

	Cast Aluminum	Cast Brass	Use with:
Single	3711A	3731	20A,
Double	3712A	3732	30A
DSFD	3781A	3782	50A

Note: 3/4" NPT Hole Std.

Additional Accessories Are Available. Consult Factory.

45° Angle Adapter

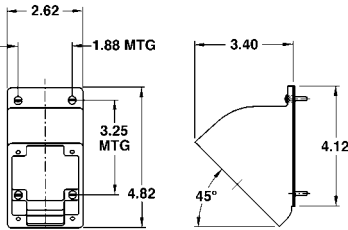

Catalog Number 3678A

Cast Aluminum	Cast Brass
3678A	3678B

Conduit Adapter Kits (Plugs or Connectors)



Size	20 Amp	30 Amp	50 Amp
1/2"	9X2C50	—	—
3/4"	9X2C75	9X3C75	9X5C75
1"	—	9X3C10	9X5C10

Note: _ Suffix to plugs/connectors for assembly from factory.

Screw Cap / Cup Cap



	20 Amp	30 Amp	50 Amp
Screw Cap (Connector)	9X2PSC	9X3PSC	9X5PSC
Cup Cap (Plug)	—	F26874C	F26874C

Cable Bushings

Max. Cable O.D. (Inches)	20 Amp	30 & 50 Amp
0.375	C16984A	
0.437	C16984B	
0.500	C16984C	
0.545		2000-11
0.562	C16984D	
0.606	B16506	
0.620		2000-03
0.625	B16524	
0.700		2000-04
0.750		2000-01
0.800		2000-06
0.870		2000-02
0.925		2000-12
1.000		2000-05

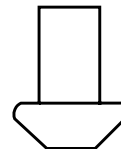

20 Amp Cable Bushing

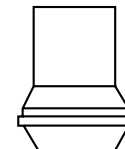

30 & 50 Amp Cable Bushing

Material – oil resistant neoprene.



State Catalog number followed by slash/ _ and bushing code; Example: 9P33U1/1000

(Minimum Limit 85% of O.D. Size for Sealing)

Russellstoll[®]**DuraGard[®] Waterproof Connections – Accessories**

Washdown Duty, Chemical, Outdoor, Industrial & Marine Use Non-Metallic Plugs, Connectors Receptacles & Inlets – 20, 30 & 50 Amp, Maximum 600 VAC/250 VDC

Replacement Interiors

Amps	Voltage Polarization	Catalog Numbers	
		Male Interior Assembly 	Female Interior Assembly 
2P3W 20A	125VAC	9XM23U1	9XF23U1
	250VAC	9XM23U2	9XF23U2
	277VAC	9XM23U3	9XF23U3
	480VAC	9XM23U4	9XF23U4
	600VAC	9XM23U5	9XF23U5
	thru 600VAC / 250VDC	9XM23U0	9XF23U0
2P3W 30A	125VAC	9XM33U1	9XF33U1
	250VAC	9XM33U2	9XF33U2
	277VAC	9XM33U3	9XF33U3
	480VAC	9XM33U4	9XF33U4
	600VAC	9XM33U5	9XF33U5
	thru 600VAC / 250VDC	9XM33U0	9XF33U0
2P3W 50A	125VAC	9XM53U1	9XF53U1
	250VAC	9XM53U2	9XF53U2
	480VAC	9XM53U4	9XF53U4
	600VAC	9XM53U5	9XF53U5
	thru 600VAC / 250VDC	9XM53U0	9XF53U0
3P4W 20A	125VAC	9XM24U1	9XF24U1
	250VAC	9XM24U2	9XF24U2
	480VAC	9XM24U4	9XF24U4
	600VAC	9XM24U5	9XF24U5
	thru 600VAC / 250VDC	9XM24U0	9XF24U0
3P4W 30A	125VAC	9XM34U1	9XF34U1
	250VAC	9XM34U2	9XF34U2
	480VAC	9XM34U4	9XF34U4
	600VAC	9XM34U5	9XF34U5
	thru 600VAC / 250VDC	9XM34U0	9XF34U0
3P4W 50A	125VAC	9XM54U1	9XF54U1
	250VAC	9XM54U2	9XF54U2
	480VAC	9XM54U4	9XF54U4
	600VAC	9XM54U5	9XF54U5
	thru 600VAC / 250VDC	9XM54U0	9XF54U0