

Russellstoll®

UniGard™ Watertight and Splashproof Pin and Sleeve Devices IP67 and IP44

20 Amp



IP67 Shown

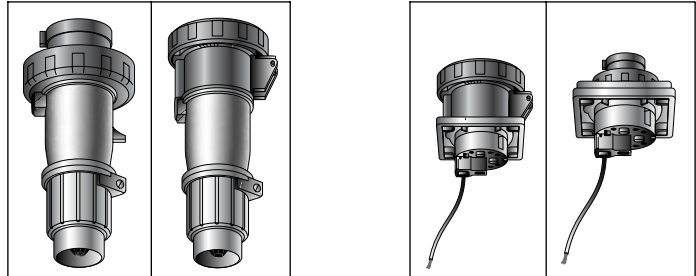

Russellstoll®

WATERTIGHT IP67

Poles & Wires	Configuration			Voltage/ Color Coding	Plug	Connector	Cable O.D. Range Inches	Receptacle*	Inlet*
	Receptacle/ Connector	Plug/ Inlet	Clock Hour						
2P3W			4h	125	RS320P4W	RS320C4W	.57-.71	RS320R4W	RS320B4W
2P3W			6h	250	RS320P6W	RS320C6W	.57-.71	RS320R6W	RS320B6W
2P3W			5h	277	RS320P5W	RS320C5W	.57-.71	RS320R5W	RS320B5W
2P3W			7h	480	RS320P7W	RS320C7W	.57-.71	RS320R7W	RS320B7W
3P4W			12h	125/250	RS420P12W	RS420C12W	.57-.71	RS420R12W	RS420B12W
3P4W			9h	3Ø250	RS420P9W	RS420C9W	.57-.71	RS420R9W	RS420B9W
3P4W			7h	3Ø480	RS420P7W	RS420C7W	.57-.71	RS420R7W	RS420B7W
3P4W			5h	3Ø600	RS420P5W	RS420C5W	.57-.71	RS420R5W	RS420B5W
4P5W			9h	3ØY120/208	RS520P9W	RS520C9W	.57-.71	RS520R9W	RS520B9W
4P5W			7h	3ØY277/480	RS520P7W	RS520C7W	.57-.71	RS520R7W	RS520B7W
4P5W			5h	3ØY347/600	RS520P5W	RS520C5W	.57-.71	RS520R5W	RS520B5W

IP44 Construction: No screw collars on male devices; female devices have flap covers only.

Poles & Wires	Configuration			Voltage/ Color Coding	Plug	Connector	Cable O.D. Range Inches	Receptacle*	Inlet*
	Receptacle/ Connector	Plug/ Inlet	Clock Hour						
2P3W			4h	125	RS320P4S	RS320C4S	.57-.71	RS320R4S	RS320B4S
2P3W			6h	250	RS320P6S	RS320C6S	.57-.71	RS320R6S	RS320B6S
2P3W			5h	277	RS320P5S	RS320C5S	.57-.71	RS320R5S	RS320B5S
3P4W			12h	125/250	RS420P12S	RS420C12S	.57-.71	RS420R12S	RS420B12S
3P4W			9h	3ph.250	RS420P9S	RS420C9S	.57-.71	RS420R9S	RS420B9S
4P5W			9h	3ph.120/208	RS520P9S	RS520C9S	.57-.71	RS520R9S	RS520B9S

*See Page H81 for back box/mounting options.

UL Listing E2630, E47956
UL Classification E205590

Liquidtight Conduit Adapter Kit

2LTK4C50	20A 3 & 4PW 1/2" NPT
3LTK4C75	20A 5W 3/4" NPT

Russellstoll®

UniGard™ Watertight and Splashproof Pin and Sleeve Devices IP67 and IP44

30 Amp



IP67 Shown

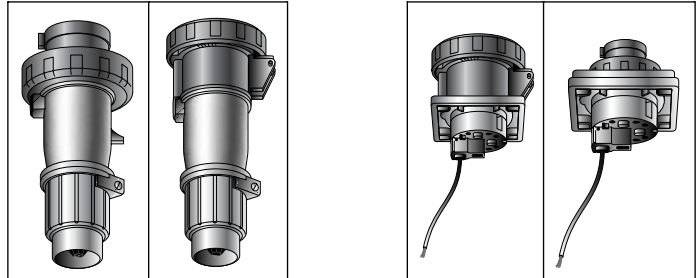

	Poles & Wires	Configuration			Voltage/ Color Coding	Plug	Connector	Cable O.D. Range Inches	Receptacle*	Inlet*
		Receptacle/ Connector	Plug/ Inlet	Clock Hour						
WATERTIGHT IP67	2P3W			4h	125	RS330P4W	RS330C4W	.675-.91	RS330R4W	RS330B4W
	2P3W			6h	250	RS330P6W	RS330C6W	.675-.91	RS330R6W	RS330B6W
	2P3W			7h	480	RS330P7W	RS330C7W	.675-.91	RS330R7W	RS330B7W
	3P4W			12h	125/250	RS430P12W	RS430C12W	.675-.91	RS430R12W	RS430B12W
	3P4W			9h	3Ø250	RS430P9W	RS430C9W	.675-.91	RS430R9W	RS430B9W
	3P4W			7h	3Ø480	RS430P7W	RS430C7W	.675-.91	RS430R7W	RS430B7W
	3P4W			5h	3Ø600	RS430P5W	RS430C5W	.675-.91	RS430R5W	RS430B5W
	4P5W			9h	3ØY120/208	RS530P9W	RS530C9W	.675-.91	RS530R9W	RS530B9W
	4P5W			7h	3ØY277/480	RS530P7W	RS530C7W	.675-.91	RS530R7W	RS530B7W
	4P5W			5h	3ØY347/600	RS530P5W	RS530C5W	.675-.91	RS530R5W	RS530B5W

IP44 Construction: No screw collars on male devices; female devices have flap covers only.

SPLASHPROOF IP44	2P3W			4h	125	RS330P4S	RS330C4S	.675-.91	RS330R4S	RS330B4S
	2P3W			6h	250	RS330P6S	RS330C6S	.675-.91	RS330R6S	RS330B6S
	2P3W			5h	277	RS330P5S	RS330C5S	.675-.91	RS330R5S	RS330B5S
	3P4W			12h	125/250	RS430P12S	RS430C12S	.675-.91	RS430R12S	RS430B12S
	3P4W			9h	3ph.250	RS430P9S	RS430C9S	.675-.91	RS430R9S	RS430B9S
	4P5W			9h	3ph.120/208	RS530P9S	RS530C9S	.675-.91	RS530R9S	RS530B9S

*See Page H81 for back box/mounting options.

UL Listing E2630, E47956
UL Classification E205590

Liquidtight Conduit Adapter Kit

3LTK4C50	30A 3 & 4W 1/2" NPT
3LTK4C10	30A 3 & 4W 1" NPT
3LTK4C75	30A 3 & 4W 3/4" NPT
3LTK5C75	30A 5W 3/4" NPT
3LTK5C10	30A 5W 1" NPT

Thomas & Betts

Russellstoll®

UniGard™ Watertight Pin and Sleeve Devices IP67

60 Amp

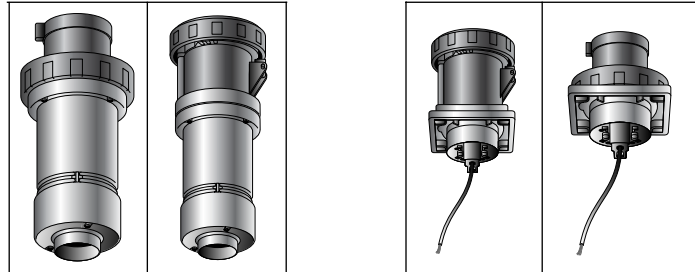

Poles & Wires	Configuration			Voltage/ Color Coding	Plug	Connector	Cable O.D. Range Inches	Receptacle*	Inlet*
	Receptacle/ Connector	Plug/ Inlet	Clock Hour						
2P3W			4h	125	RS360P4W	RS360C4W	.937-1.375	RS360R4W	RS360B4W
2P3W			6h	250	RS360P6W	RS360C6W	.937-1.375	RS360R6W	RS360B6W
2P3W			5h	277	RS360P5W	RS360C5W	.937-1.375	RS360R5W	RS360B5W
2P3W			7h	480	RS360P7W	RS360C7W	.937-1.375	RS360R7W	RS360B7W
2P3W			3h	250DC	RS360P3W	RS360C3W	.937-1.375	RS360R3W	RS360B3W
3P4W			12h	125/250	RS460P12W	RS460C12W	.937-1.375	RS460R12W	RS460B12W
3P4W			9h	3Ø250	RS460P9W	RS460C9W	.937-1.375	RS460R9W	RS460B9W
3P4W			7h	3Ø480	RS460P7W	RS460C7W	.937-1.375	RS460R7W	RS460B7W
3P4W			5h	3Ø600	RS460P5W	RS460C5W	.937-1.375	RS460R5W	RS460B5W
4P5W			9h	3ØY120/208	RS560P9W	RS560C9W	.937-1.375	RS560R9W	RS560B9W
4P5W			7h	3ØY277/480	RS560P7W	RS560C7W	.937-1.375	RS560R7W	RS560B7W
4P5W			5h	3ØY347/600	RS560P5W	RS560C5W	.937-1.375	RS560R5W	RS560B5W

*See Page H81 for back box/mounting options.

UL Listing E2630, E47956
UL Classification E205590

Liquidtight Conduit Adapter Kit*

6LTK5C75 60A 5W ¾" NPT

6LTK5C10 60A 5W 1" NPT

*Additional sizes available on request.

Note: All UniGard 60 & 100 Amp devices ship standard with IEC 309-1 configuration "pilot" pin/sleeves used for auxillary contact service.

Special construction without these pilot contacts is available.
(Add "XC" to end of cat. no.)

Russellstoll®

WATERTIGHT IP67

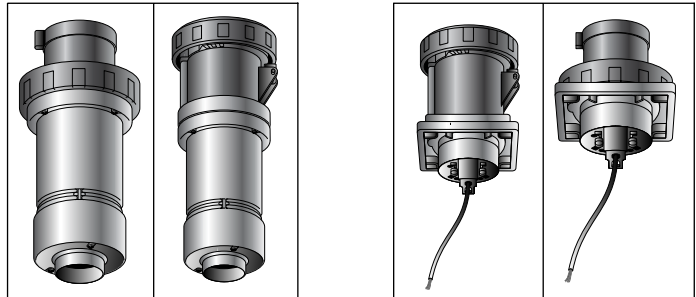
Russellstoll[®]**UniGard™ Watertight Pin and Sleeve Devices IP67****100 Amp**

	Poles & Wires	Configuration			Voltage/ Color Coding	Plug	Connector	Cable O.D. Range Inches	Receptacle*	Inlet*
		Receptacle/ Connector	Plug/ Inlet	Clock Hour						
WATERTIGHT IP67	2P3W**			6h	250	RS3100P6W	RS3100C6W	1.2650- 1.790	RS3100R6W	RS3100B6W
	2P3W**			7h	480	RS3100P7W	RS3100C7W	1.2650- 1.790	RS3100R7W	RS3100B7W
	3P4W			12h	125/250	RS4100P12W	RS4100C12W	1.2650- 1.790	RS4100R12W	RS4100B12W
	3P4W			9h	3Ø250	RS4100P9W	RS4100C9W	1.2650- 1.790	RS4100R9W	RS4100B9W
	3P4W			7h	3Ø480	RS4100P7W	RS4100C7W	1.2650- 1.790	RS4100R7W	RS4100B7W
	3P4W			5h	3Ø600	RS4100P5W	RS4100C5W	1.2650- 1.790	RS4100R5W	RS4100B5W
	4P5W			9h	3ØY120/208	RS5100P9W	RS5100C9W	1.2650- 1.790	RS5100R9W	RS5100B9W
	4P5W			7h	3ØY277/480	RS5100P7W	RS5100C7W	1.2650- 1.790	RS5100R7W	RS5100B7W
	4P5W			5h	3ØY347/600	RS5100P5W	RS5100C5W	1.2650- 1.790	RS5100R5W	RS5100B5W

*See Page H81 for back box/mounting options.

**Alternate vendor supplied item; construction features will vary from specs in this catalog. Full IEC approval and mating guaranteed. Contact Technical Services for inlet/receptacle mounting components.

UL Listing E2630, E47956
UL Classification E205590

Liquidtight Conduit Adapter Kit

10LTK5C10 ▼	100A 4W, 5W 1" NPT
10LTK5C125 ▼	100A 4W, 5W 1.25" NPT
10LTK5C150 ▼	100A 4W, 5W 1.50" NPT

Note: All UniGard 60 & 100 Amp devices ship standard with IEC 309-1 configuration "pilot" pin/sleeves used for auxillary contact service.

Special construction without these pilot contacts is available.
(Add "XC" to end of cat. no.)

▼ For 4 wire and 5 wire plugs and connectors only, contact Technical Services for 3 wire plug and connector conduit adapters. 100A 3 wire plugs and connectors use PG48 backhandle thread.